

ABERNATHY and ASSOCIATES

Kenneth B. Abernathy Jr.

Wisconsin Registered Land Surveyor S-1594

Rt. 3, Box 273  
Elkhorn, Wisconsin 53121  
Phone: (414) 723-4260 (office)  
(414) 723-4813 (residence)

PLAT OF SURVEY

Parcel "E"  
0.363 Acres ±

50

49

48

47

Parcel "E"  
The Easterly 30.87 feet of Lot 49 and the Westerly 51.72 feet of Lot 48 of Glenwood Terrace Subdivision, as recorded in Volume 10, Page 11 of Plats, Dated July 2, 1928, being located in the North 1/2 of the Northeast 1/4 of the Northeast 1/4 of Section 23, Town 1 North, Range 16 East, Village of Fontana, County of Walworth, State of Wisconsin, more particularly described as follows:

Commencing at a Found Concrete Monument at the Northeast Corner of said Section 23, thence S 87°28'00" W along the North Line of said Section 33.00 feet to a Found Concrete Monument on the West Right-of-way Line of Indian Hills Road; thence continue S 87°28'00" E along said Section Line 897.58 feet (recorded as 898.58 feet) to an Iron Pipe at a point 20.56 feet (recorded as 20.58 feet) Westerly of the Northeast Corner of Lot 48 and the point of beginning; thence continue S 87°28'00" W along said Section Line 82.25 feet (recorded as 82.29 feet) to an Iron Pipe; thence S 2°35'48" E 192.23 feet (recorded as 192.30 feet) to an Iron Pipe on the North Right-of-way Line of Berwyn Drive; thence N 87°28'27" E along said North Right-of-way Line 82.22 feet (recorded as 82.29 feet) to an Iron Pipe; thence N 2°35'12" W 192.24 feet (recorded as 192.30 feet) to the point of beginning. Said parcel contains 0.363 Acres of land more or less and is subject to easements recorded or unrecorded.

Legend

- FOUND IRON PIPE
- FOUND IRON ROD
- FOUND BRASS CAPPED MONUMENT
- FOUND CONCRETE MONUMENT
- CHISEL CUT IN CONCRETE
- SET IRON PIPE, 24" LONG, WEIGHING 1.13 LBS./LINEAL FT., 1" DIA.
- SET IRON ROD, 30" LONG, WEIGHING 4.5 LBS./LINEAL FT., 1-11/16" DIA.
- (xx) RECORDED AS DIMENSION
- EXISTING FENCE

Owners: Glenwood Terrace Limited Partnership

Ordered by: John O'Neill  
O'Neill Builders, Inc.  
Post Office Box 351  
Fontana, Wisconsin

53125-0351

40' Wide

Berwyn Drive

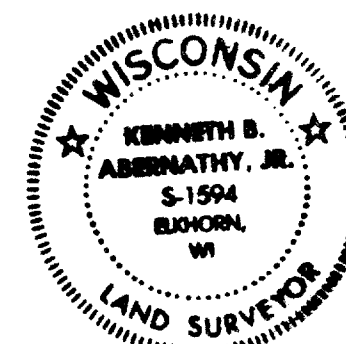

SCALE: 1"= 20 FEET

"I hereby certify that I have surveyed the above described property and that the above map is a true representation thereof and shows the size and location of the property, its exterior boundaries, the location of all visible structures and dimensions of all principal buildings thereon, boundary fences, apparent easements, roadways and visible encroachments, if any."

"This survey is made for the use of the present owners of the property, and also those who purchase, mortgage or guarantee the title thereto within one year from date hereof."

Kenneth B. Abernathy, Jr.  
WISCONSIN REGISTERED LAND SURVEYOR,  
S-1594

Date: July 22, 1994 Job No. 1994.721

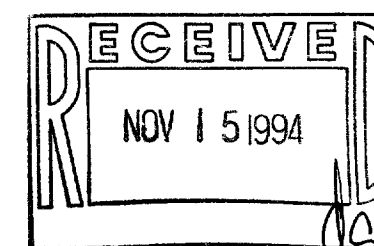

SGT-17A

005-1399